

# PRODUCT MANUAL

## BEFORE YOU BEGIN

1. Read these instructions and check to be sure all parts and tools are accounted for.
2. Please retain these installation instructions for future reference and parts ordering information.

## IMPORTANT

1. Please read the installation instructions carefully before you start.
2. If the vehicle is clean and free of other debris, it will be easy to install.
3. For your safety and to ensure a satisfactory installation, please complete all the installation steps in the order shown below.

## INSTALLATION TIPS

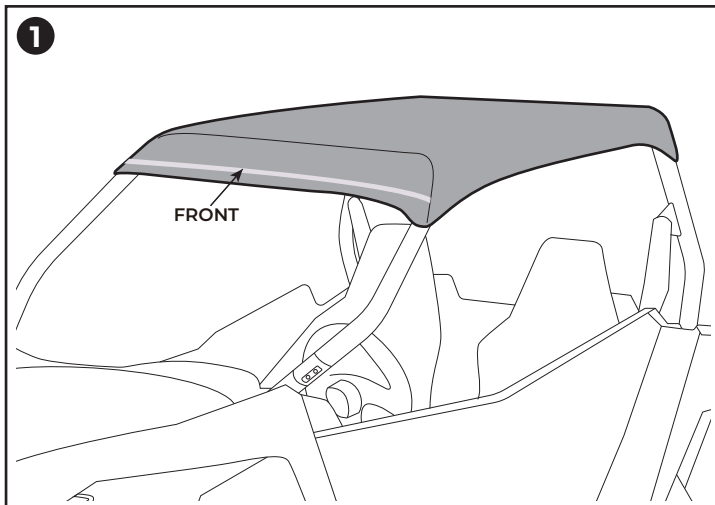

- 1 Place the soft top on the roof frame, with the "FRONT" tab toward the front of the vehicle.

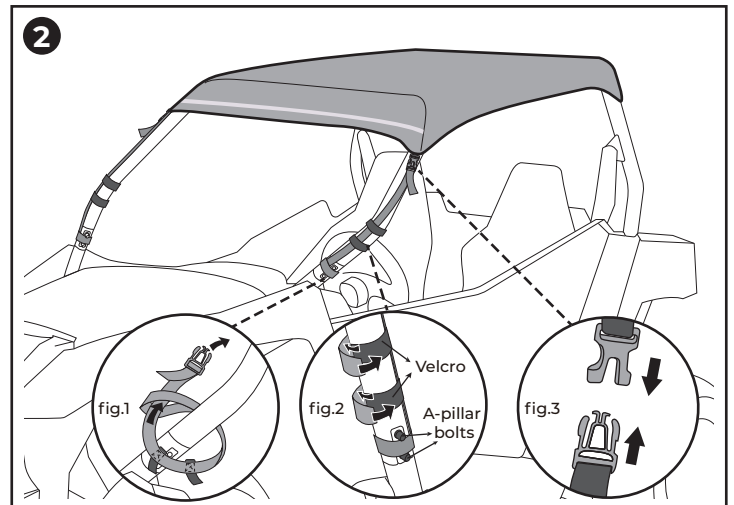

- 2 Unbuckle two front corner straps. Cinch the straps down between the two A-pillar bolts to keep them in place (**fig.1**). Attach the Velcro strips to roll bar (**fig.2**). Reinsert the buckle to the soft top (**fig.3**).

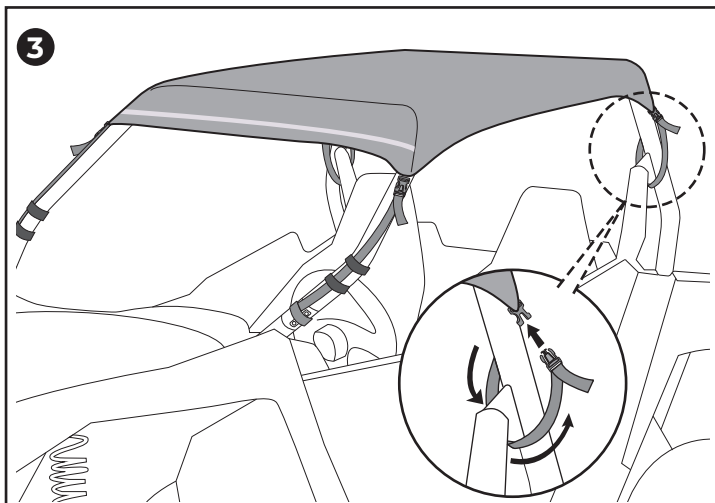

- 3 Unbuckle two rear corner straps. Route the buckle down around the seat belt mounting bracket and loop back up to the soft top.

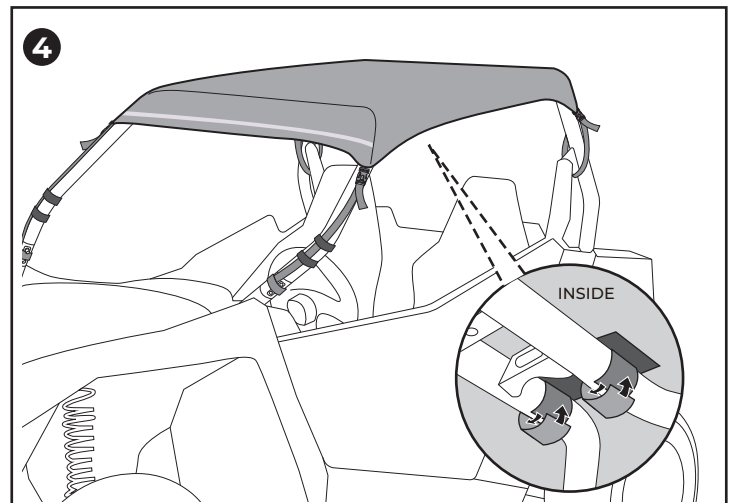

- 4 Attach the two Velcro straps on top of the soft top to the roof frame.
- 5 Tighten all buckle straps on four corners. Finish installation.

### NOTE:

*It is recommended the soft top is removed during transportation (trailing). The soft top is equipped with quick release buckles for ease in removing and installing.*